

IG-8070-047**Installation Guide for Sprung Loaded Vent Valve Kit – 770-1750-SP**

- 1) Follow the instructions in UM-8070 (Section 4.5 – Dismantling and Re-Assembly) to remove the switch end cap from the housing. Please take careful note of all the cautions and warnings contained within the manual especially in relation to the handling of PCB's.

2)

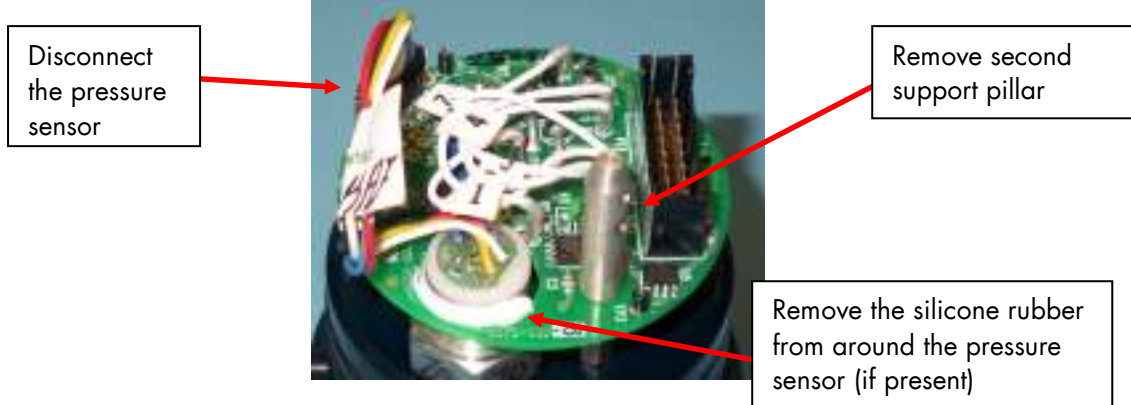

- 3) Lift the PCB off the pillars, taking care not to damage the pin in the switch shaft, and feed the pressure sensor lead through the hole in the board.

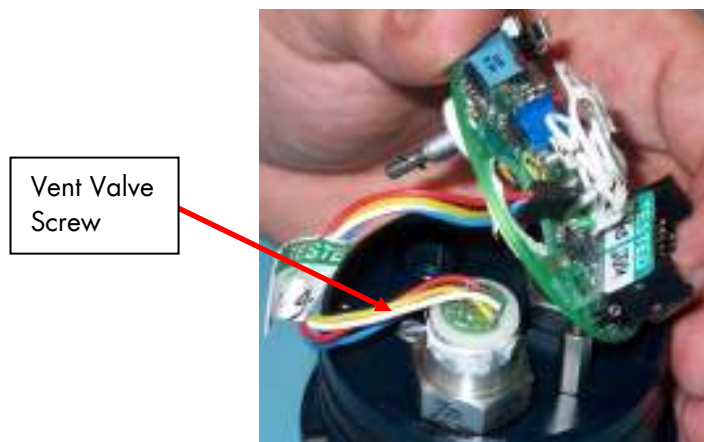

- 4) Use a screwdriver to push the vent valve open. Use a pair of pliers to securely hold the vent valve while undoing the screw. Discard the old "red" vent plug and securing screw. Ensure the bore from which the vent plug was removed is clean and free of debris.



- 5) Lightly grease (Vaseline or Molykote 44 medium) the o-rings provide in the kit and fit to the new vent plug. Fit the PVC bush to the spring (note the bush is push fit into the spring). Place a small amount of Loctite 243 (or similar) onto the screw provided. Assemble the vent valve into the end cap as shown (note the vent valve can only be fitted one way round). The screw should be tightened till it bottoms out in the vent valve.

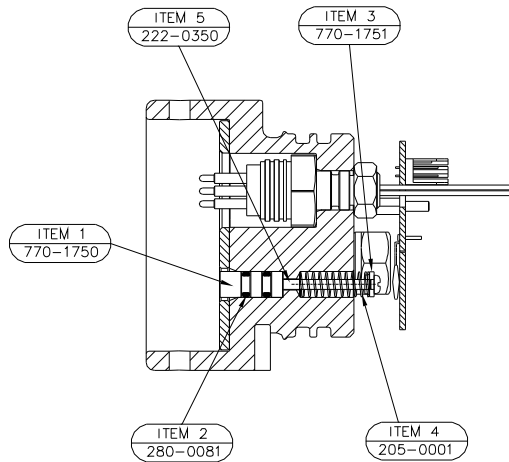

- 6) Re-fit the PCB to the end cap ensuring that the pin in the ON-OFF switch engages with the slot in the mechanics.



- 7) Secure the PCB to the end cap, reconnect the pressure sensor.
- 8) Re-assemble the switch end cap to the beacon following the instructions in UM-8070 (Section 4.5 – Dismantling and Re-Assembly).